



**LB** 1-phase  
50Hz

Compact, light and powerful  
- for professional use

The TSURUMI LB-pumps are small and robust submersible contractor's pumps with a wide range of applications wherever water has to be moved.



**Top Discharge**

Pumped water flows between the outer cover and the motor, cooling the motor and discharging as illustrated (forced motor cooling). The pump can be run continuously in air.

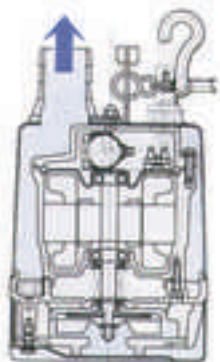

**Electrode auto control system available**

Handles like a non-automatic pump - no special installation procedures. Sensitive electrodes detect water to start up pump operation even when foreign matters are present. Relay sensor completely molded in resin and covered by rubber case for protection against rough handling.



**Components:**

001 Cable	050 Motor cover
020 Pump casing	051 Head cover
021 Impeller	052A Upper bearing
022 Suction plate	052B Lower bearing
023 Strainer	053 Miniature protector
025 Mechanical seal	054 Shaft
026 Oil sealing	055 Rotor
029 Oil casing	056 Stator
030 Oil lifter	064 Motor casing
031 Wear plate	065 Jacket
032 Outlet	068 Handle
035 Oil plug	071 Shaft sleeve
036 Lubricant	076 Condensor

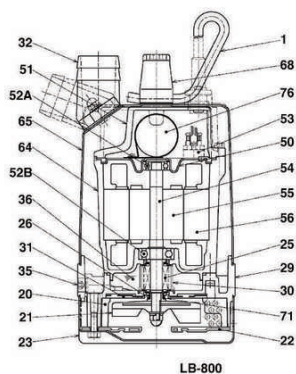

## Specifications:

Model	Colour code curve	Bore mm	Motor output kW	Rated current A	Head max. m	Capacity max. l/min	Dry weight kg w/o cable	Max. solid handling ø mm	Max. water depth m	Cable length m
LB-480	1	50	0,48	2,9	11,0	225	10,4	6	20	10
LB-480A		50	0,48	2,9	11,0	225	11,0	6	20	10
LB-800	2	50	0,75	5,0	15,0	310	13,2	6	20	10
LB-800A		50	0,75	5,0	15,0	310	13,8	6	20	10
LB-1500	3	50	1,5	15,4	17,5	440	33,0	6	50	10

ø Discharge bore mm		50		
Pumping Fluid	Temperature	0-40°C		
	Type of Fluid	Spring water, Rain water, Ground water, Sand carrying water		
Pump	Components	Impeller	Semi-Vortex impeller	
		Shaft Seal	Double mechanical seal	
		Bearings	Shielded ball bearings	
	Material	Impeller	Urethane rubber, Chromium iron casting	
		Casing	Ethylene propylene rubber	
		Suction Plate	Steelplate+Urethane rubber	
	Shaft Seal	Silicon carbide in oil bath		
Motor	Type, Poles		Induction motor, 2 poles, IP68	
	Lubrication		Turbine oil (ISO VG32)	
	Motor Protector (built-in)		Miniature protector, Circle thermal cut-out	
	Insulation		Insulation class E, Insulation class B	
	Phase / Voltage		Single phase 230V / 110V / 50Hz	
	Material	Casing	Aluminium die casting	
Shaft		Stainless steel EN-X6Cr13		
Cable		Rubber, H07RN-F		
Discharge Connection		Threaded flange/Hose coupling		

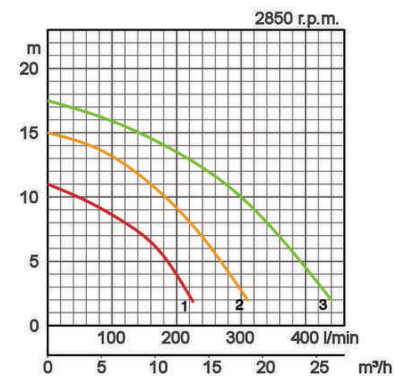

## Dimensions in mm:

Model	d	A	A1	B	D	D1	H	W1
LB-480	50	187	161	286	231	-	228	50
LB-480A	50	187	161	286	231	223	228	115
LB-800	50	187	160	341	230	-	283	50
LB-800A	50	187	160	341	230	223	283	170
LB-1500	50	187	122	600	-	-	518	80

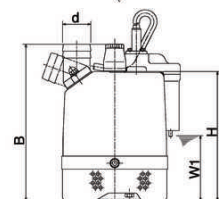
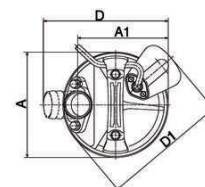

W1: continuous running water level

In the event of abrasive and corrosive utilization, stronger wear and tear will take place naturally in certain components. In this regard, please pay attention to our website [www.tsurumi.eu/english/applications.htm](http://www.tsurumi.eu/english/applications.htm).

